



**Reconnecting the
TV Meter
Remote Control**

**Having trouble selecting
your Avatar with the TV
Meter remote control?**

Step 1:

Click **settings ⚙️ in the bottom right of the TV Meter, press **Yes** to enter the settings menu**

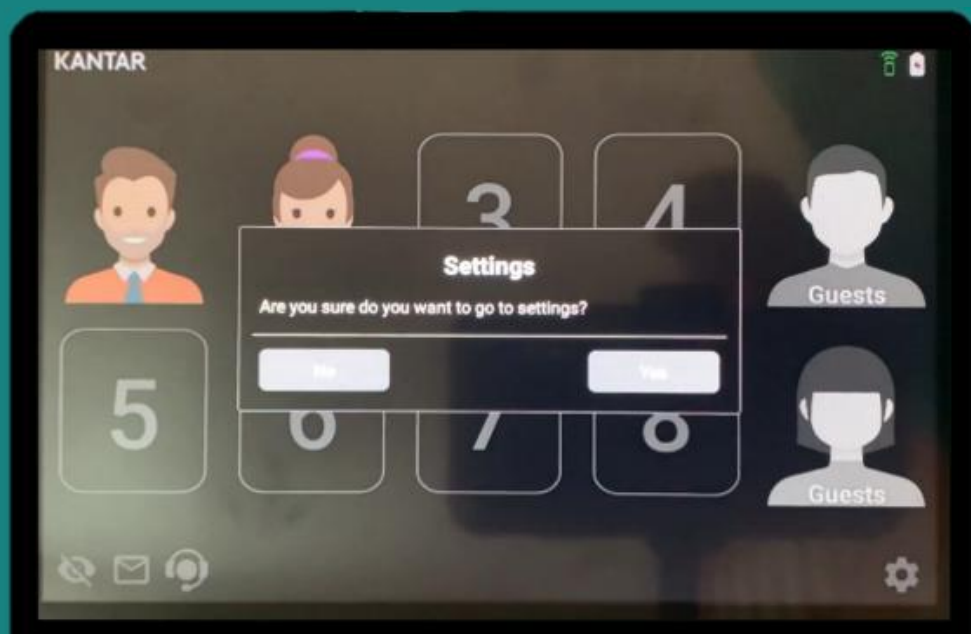

Step 2: Select Remote Control Pairing

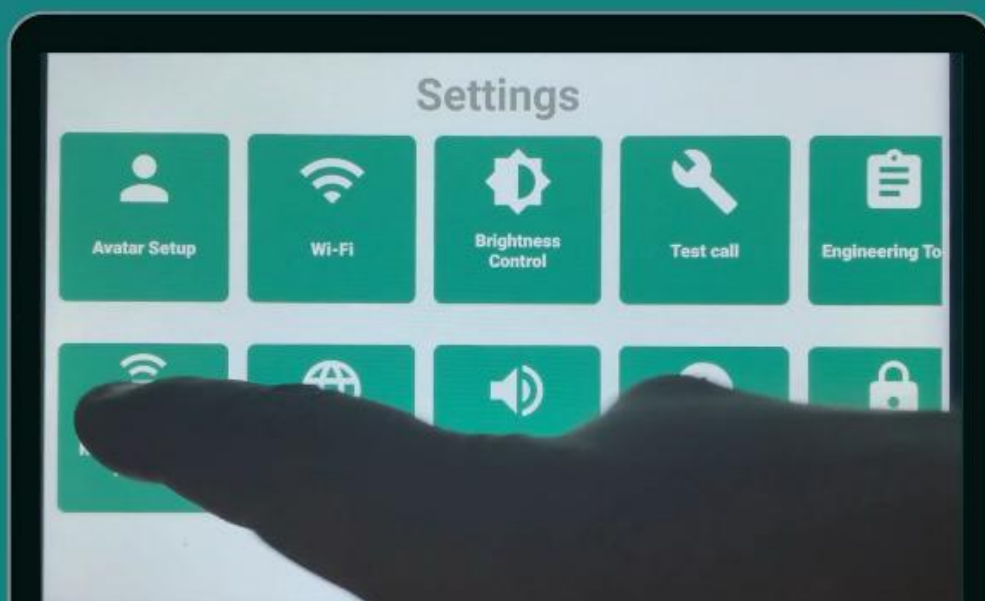

Step 3:
Hold in the OK and +
buttons on the Remote
for 5 seconds the red
light stars flashing



Please Note:
If the red light doesn't start
flashing on the remote
control then please
change the batteries

Step 4:

Once the red light flashes
press **Scan** on the TV Meter
after a few seconds **NGPM
Handset** will be displayed

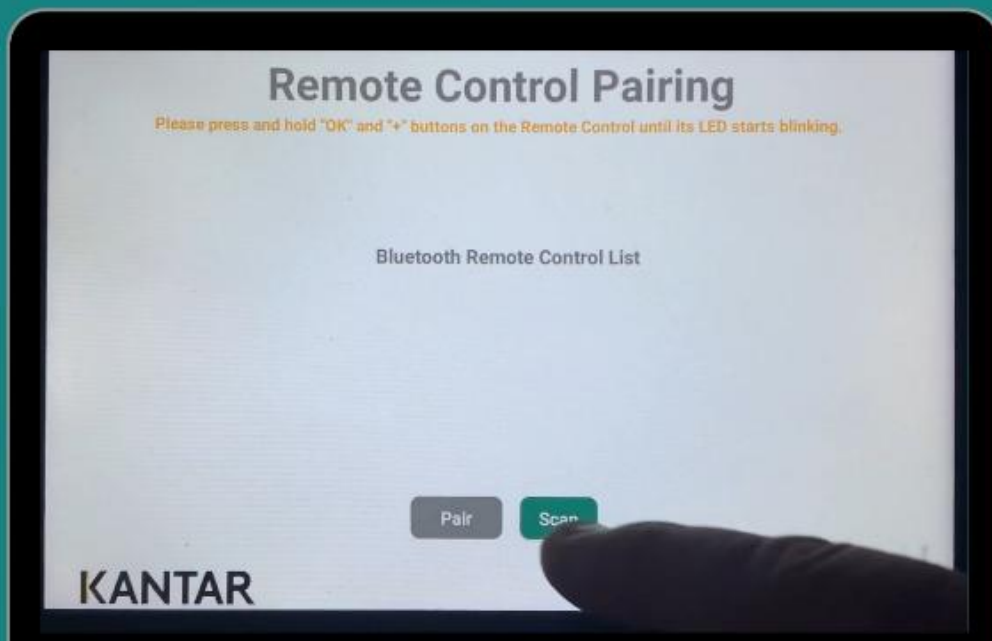

Step 5:
Press **Pair** on the TV Meter it
will display **Pairing process
successful** if not repeat the
process from Step 3

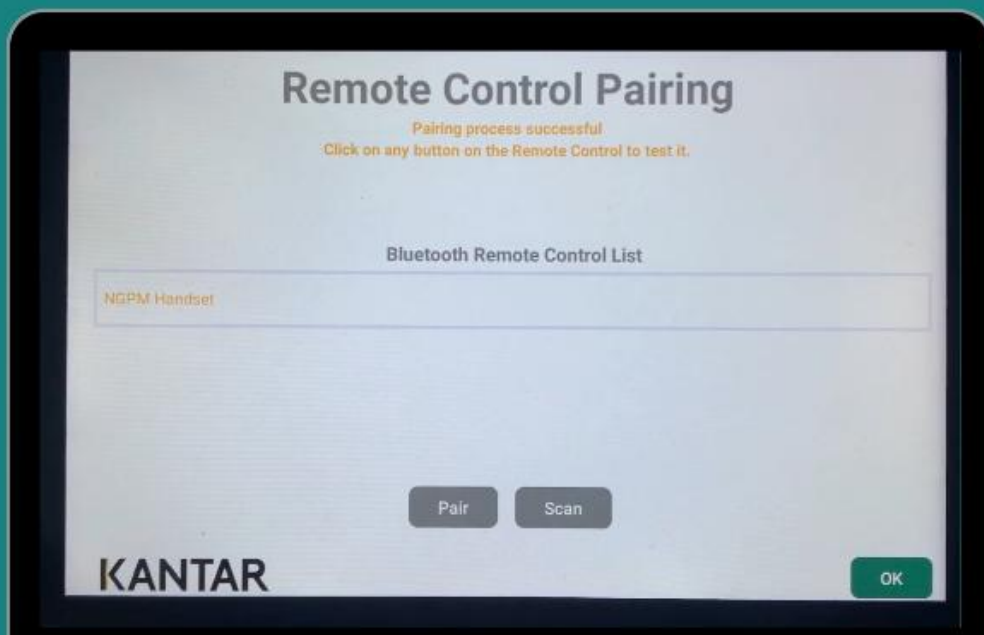

Step 6:
Press **OK** then press **Exit** to
complete. Your TV Meter
remote control is now back
up and running correctly

